



High Performance Driving



RAE DC PRODUCTS GROUP

A BLUFFTON MOTOR WORKS COMPANY



RAE M4000 Permanent Magnet DC Motors

What to drive for your demanding applications

- Speeds up to 3500 rpm
- 1/30 hp up to 1/4 hp
- Flexible to meet your needs. Electronic controls, mounting options, gear drives and more

■ TOP QUALITY, RELIABLE PRODUCTS ■ ON TIME, EVERY TIME ■ MAXIMIZE INVESTMENT

High Performance RAE M4000 Permanent Magnet DC Motors

RAE M4000 DC motors are available with various options and value added features to meet your application needs. These include special output shaft modifications, specialty brackets, end bell modifications, gear drives, electronic controls, brakes, encoders, junction boxes, special lead or harness assemblies and special terminals or plugs. We can also provide private label or special label product, custom colors and specialty packaging.

Features

- NEMA Class F Insulation
- Foot or Flange Mounting
- High Energy Ceramic Magnets
- Double Shielded Ball Bearings
- Dynamically Balanced Armature
- Reversible Design
- TENV Enclosure
- Externally Replaceable Brushes
- Auto-Hook Tang Type Commutator
- Drop-in Replacement for Popular Units
- Value Added Options and Modifications Available

Specifications

Continuous Torque Ratings

DC Ratings	56 to 110 in oz
SCR Ratings	28 to 56 in oz
Horsepower	1/30 to 1/4 hp
Speeds	Up to 3500 rpm
Voltages	12 to 180 V
Max. Shaft Dia.	0.500 in.
Pilot Dia.	2.015 in
Lead Length	8 in

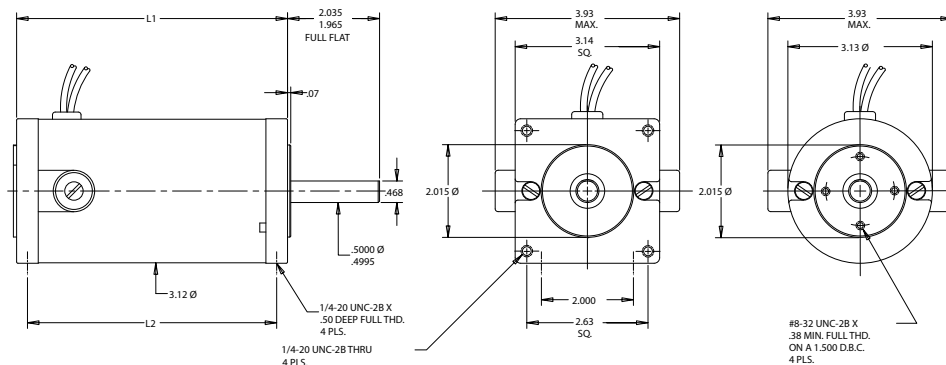

Depending on the RAE motor series chosen, the L1 dimension will be from 4.915" to 7.860."
The L2 dimension will be from 4.457" to 7.382"

Bluffton – A Wide Selection of Solutions to Meet Your Needs



AC Motors



Speed Reducers



DC Gearmotors



DC Gearmotors



AC Gearmotors

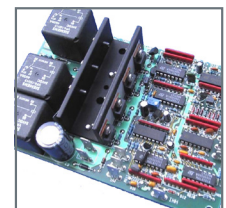

DC Controls

Quality Assurance

A Strong Quality Assurance
Commitment – 100% Testing



At RAE, quality consciousness is inherent in the production process from start to finish. Our stringent testing process includes:

- AQL sampling of incoming components
- In-process quality checks
- Meeting UL and CSA certification standards
- 100% dynamically balanced and electrically tested armature assemblies
- Hi-pot testing as well as speed and current testing at no load
- Minimum 30-minute product run-in testing



RAE DC PRODUCTS GROUP

A BLUFFTON MOTOR WORKS COMPANY

Made in the
U.S.A.

RAE DC Products Group

4615 W. Prime Parkway | McHenry, IL 60050-7037 | 815-385-3500 | www.raemotors.com

© 2014, Bluffton Motor Works.
All Rights Reserved.
RM4000-041114

■ TOP QUALITY, RELIABLE PRODUCTS ■ ON TIME, EVERY TIME ■ MAXIMIZE INVESTMENT